

Photometrics® Quick Installation Guide for PCI-Express Interface

Supported Operating Systems: Windows 7/8/10

Install the PVCAM® Driver

1. Insert the USB drive included with the camera into your computer.
2. Install PVCAM.
3. Shut down the computer after installation is complete.

Install the Interface Card and Plug in Camera

4. Install the included PCI-Express Interface card into a PCIe 4X or better slot.
5. Plug in the PCI-Express cable into the computer.

6. Plug the PCI-Express cable into the camera.
7. Provide power to the Power Supply, and plug the power connector into the Photometrics Prime camera.

Start Imaging with the Photometrics Prime

8. Turn ON the camera and wait for the amber LED (located on backplate of camera) to stop flashing.
9. Turn ON the computer.
10. When the computer has booted up, the camera is installed.

Prime™ sCMOS Camera

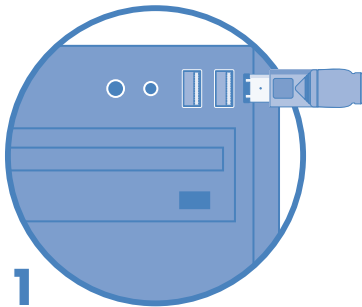

Insert the USB drive into the computer and install PVCAM.

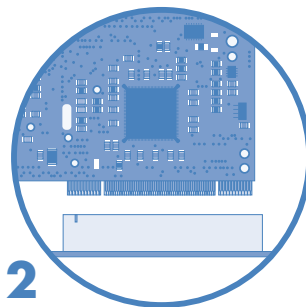

Install the PCI-Express Card.

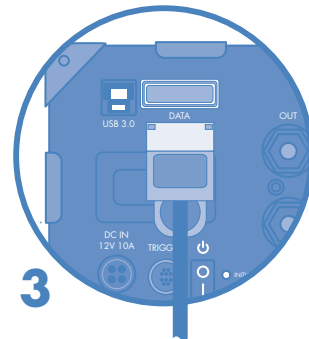

Plug the PCI-Express cable into the camera.

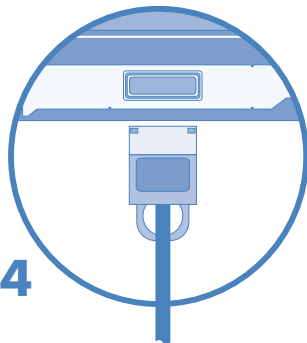

Plug the PCI-Express cable into the computer.

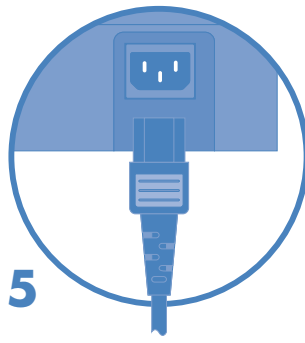

Connect the power cord to the power supply. Plug the power cord into a wall outlet. Plug the power supply into the camera.

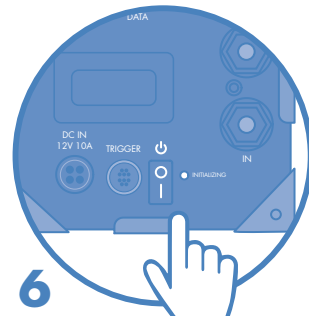

Turn on the camera. Wait 10 seconds before turning the computer on. When the LED on the back of the camera turns off, the camera is ready to image.

Photometrics® Quick Installation Guide for USB 3.0 Interface

Supported Operating Systems: Windows 7/8/10

Install the PVCAM® Drive

1. Insert the USB drive included with the camera into your computer.
2. Install PVCAM.

Plug in Camera and Start Imaging

3. Provide power to the Power Supply, and plug the power connector into the Photometrics Prime camera.

4. Turn on the camera.
5. Plug in the USB 3.0 cable into the camera.
6. Plug in the USB 3.0 cable into the computer.
7. When the LED on the back of the camera stops blinking (approximately 50 sec after turning on), the camera is ready to use.

Prime™ sCMOS Camera

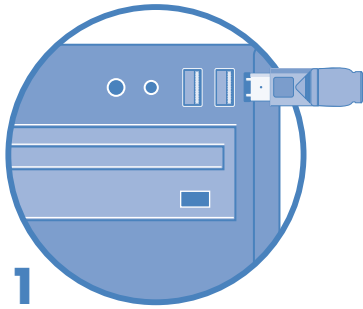

Insert the USB drive into the computer and install PVCAM.

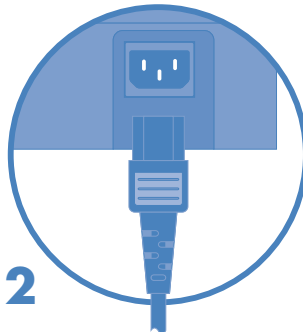

Connect the power cord to the power supply. Plug the power cord into a wall outlet. Plug the power supply into the camera.

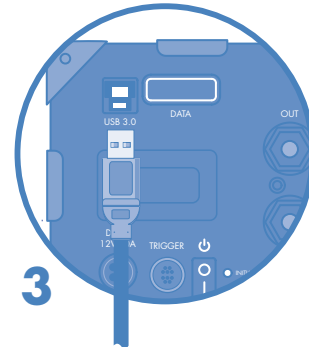

Plug the USB 3.0 cable into the camera. This camera is not compatible with USB 2.

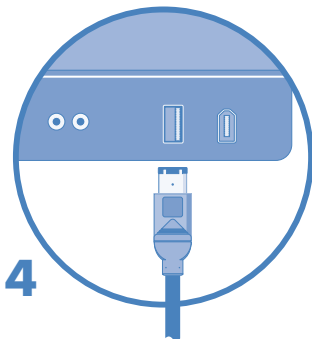

Plug the USB 3.0 cable into the computer.

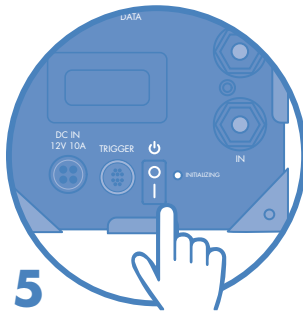

Turn on the camera. When the LED on the back of the camera turns off, the camera is ready to image.

More detailed installation instructions can be found in the camera manuals on the Photometrics flash drive.

Contact Photometrics Customer Service for additional information:

+1 800.874.9789

www.photometrics.com



Photometrics is a registered trademark.

PVCAM is a registered trademark and Prime is a trademark of Photometrics.

58-621-001 Rev A03